



<b>Championship</b>	355	170	342	360	558	165	370	502	395	3217
<b>Regular</b>	316	155	322	331	519	139	333	455	353	2923
<b>Ladies</b>	268	135	305	302	495	105	311	419	311	2651
<b>Hole Number</b>	1	2	3	4	5	6	7	8	9	OUT
<b>Handicap Stroke</b>	17	3	7	13	1	11	9	15	5	
<b>PAR</b>	4	3	4	4	5	3	4	5	4	36



- Full Service Campground
- Par 3 Golf Course
- 9 Hole Regulation Golf Course
- Licensed Restaurant



Ph. 204-326-6225



Ph. 204-326-5722

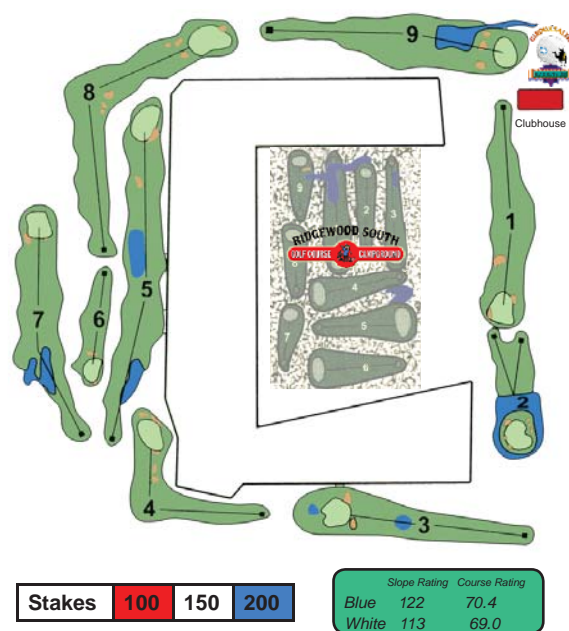

### RULES OF PLAY

- **DRESS CODE ENFORCED. SHIRTS MUST HAVE A COLLAR WITH A SLEEVE OR CAPPED SLEEVE. NO SWEAT PANTS AND SHORTS MUST BE HEMMED AND NO SHORTER THAN SIX INCHES ABOVE THE KNEE.**
- **PLEASE USE DROP BALL AREA PROVIDED ON HOLE #2. IF TEE SHOT ENTERS THE WATER HAZARD, PLAY NEXT SHOT FROM THE DROP AREA.**
- **PERSONAL ALCOHOL IS NOT ALLOWED ON GIROUXSALEM PROPERTY AS PER THE MLCC REGULATIONS.**
- **LENGTH OF PLAY - 4 HOURS AND 30 MINUTES.**
- **EACH PLAYER MUST HAVE HIS OR HER OWN CLUBS AND BAG.**
- **NO GROUPS LARGER THAN 4 PERMITTED**
- **SOFT SPIKES ONLY.**
- **REPAIR ALL BALL MARKS AND REPLACE ALL DIVOTS.**