

Championship	355	170	342	360	558	165	370	502	395	3217
Regular	316	155	322	331	519	139	333	455	353	2923
Ladies	268	135	305	302	495	105	311	419	311	2651
Hole Number	1	2	3	4	5	6	7	8	9	OUT
Handicap Stroke	17	3	7	13	1	11	9	15	5	
PAR	4	3	4	4	5	3	4	5	4	36



- Full Service Campground
- Par 3 Golf Course
- 9 Hole Regulation Golf Course
- Licensed Restaurant



Ph. 204-326-6225



Ph. 204-326-5722

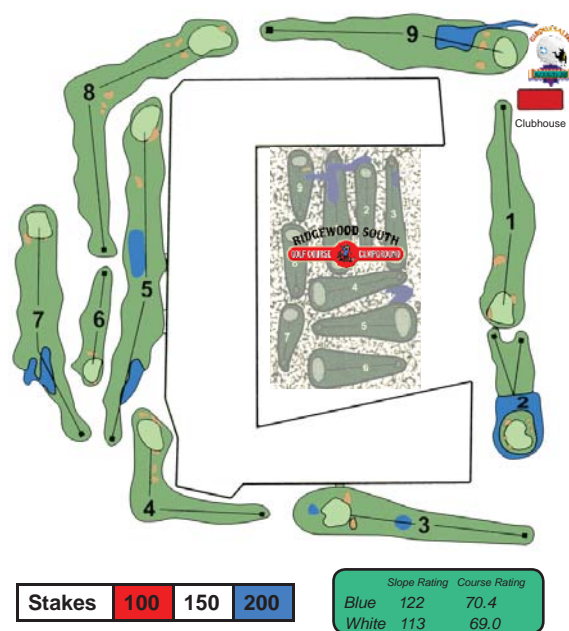

RULES OF PLAY

- **DRESS CODE ENFORCED. SHIRTS MUST HAVE A COLLAR WITH A SLEEVE OR CAPPED SLEEVE. NO SWEAT PANTS AND SHORTS MUST BE HEMMED AND NO SHORTER THAN SIX INCHES ABOVE THE KNEE.**
- **PLEASE USE DROP BALL AREA PROVIDED ON HOLE #2. IF TEE SHOT ENTERS THE WATER HAZARD, PLAY NEXT SHOT FROM THE DROP AREA.**
- **PERSONAL ALCOHOL IS NOT ALLOWED ON GIROUXSALEM PROPERTY AS PER THE MLCC REGULATIONS.**
- **LENGTH OF PLAY - 4 HOURS AND 30 MINUTES.**
- **EACH PLAYER MUST HAVE HIS OR HER OWN CLUBS AND BAG.**
- **NO GROUPS LARGER THAN 4 PERMITTED**
- **SOFT SPIKES ONLY.**
- **REPAIR ALL BALL MARKS AND REPLACE ALL DIVOTS.**



Phone 204-326-5722

355	170	342	360	558	165	370	502	395	3217	6434		
316	155	322	331	519	139	333	455	353	2923	5846		
268	135	305	302	495	105	311	419	311	2651	5302		
10	11	12	13	14	15	16	17	18	IN	TOTAL		
18	4	8	14	2	12	10	16	6				
4	3	4	4	5	3	4	5	4	36	72	HCP	NET